

Commercial
48 Catherine Street
Frome
Somerset
BA11 1DA

Rent £7,200 per annum
Ratable Value £1,425
(this is not the amount you pay)

A two story office unit located on the sought after Catherine Street, just a short walk from Catherine Hill and the town centre. There are plenty of storage spaces along with the lower ground floor Kitchenette and separate WC.

The Landlord is not looking for any Hairstylists/Barbers or food outlets

By way of a new internally insuring (with separate window cover) and repairing lease 5 year lease with terms to be agreed.

Each party is responsible for their own legal costs.



Basement
 Approx. 19.6 sq. metres (211.0 sq. feet)

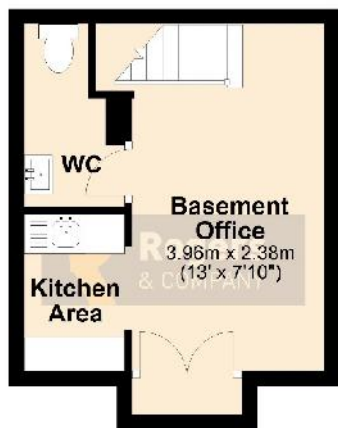

Ground Floor
 Approx. 22.8 sq. metres (245.6 sq. feet)

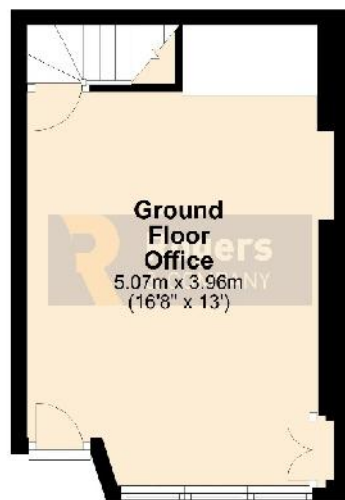

Total area: approx. 42.4 sq. metres (456.6 sq. feet)

This floor plan is a guide only
 Plan produced using PlanUp.

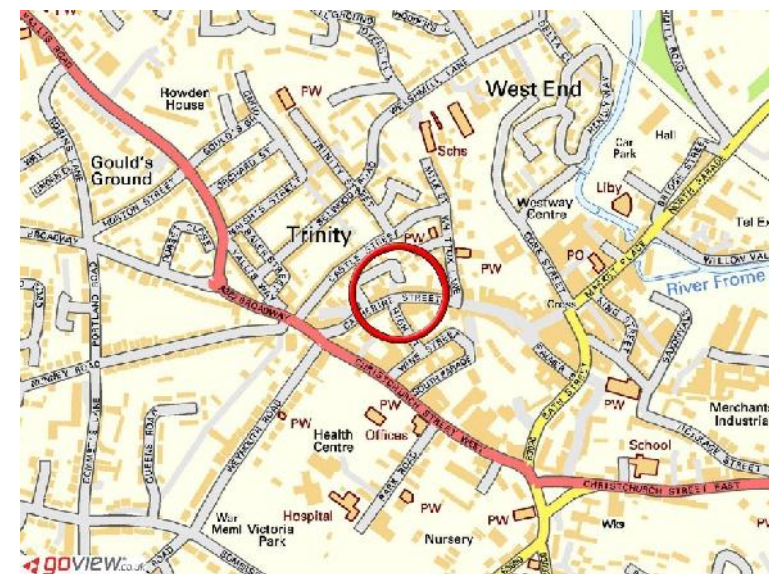

IMPORTANT: we would like to inform prospective purchasers that these sales particulars have been prepared as a general guide only. A detailed survey has not been carried out, nor the services, appliances and fittings tested. Room sizes should not be relied upon for furnishing purposes and are approximate. If floor plans are included, they are for guidance only and illustration purposes only and may not be to scale. If there are any important matters likely to affect your decision to buy, please contact us before viewing the property.

24 Bath Street, Frome, Somerset, BA11 1DJ
 T 01373 454 335
 E info@rogersandcompany.co.uk
 rogersandcompany.co.uk

